

# AUXILIARY VIEWS - ORTHOGRAPHIC DRAWING

## QUESTION

Complete the auxiliary view, of the top surface of the object shown opposite. Details and dimensions of the object are shown on the right.

Please note: the auxiliary view will show the true size and shape of the top surface.

HELPFUL LINK:

[https://technologystudent.com/despro\\_3/auxil8.html](https://technologystudent.com/despro_3/auxil8.html)

HELPFUL LINK

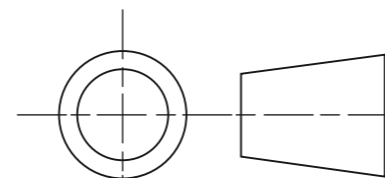

THIRD ANGLE PROJECTION

## ISOMETRIC

TOP SURFACE

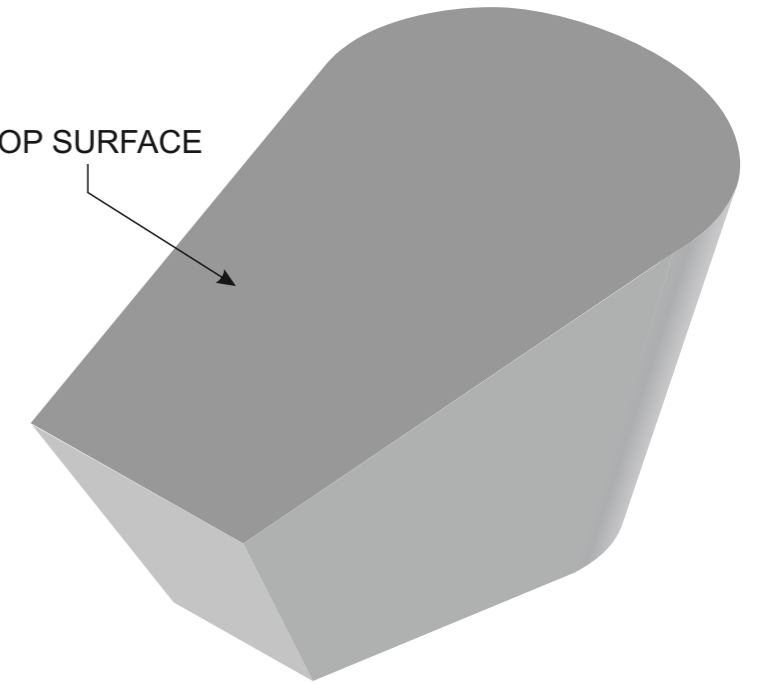

## DIMENSIONS

(not drawn to scale)

