

PRODUCT DEVELOPMENT THE WORKING DRAWING AND ISOMETRIC VIEW

V.Ryan © 2000 - 2012

On behalf of The World Association of Technology Teachers

W.A.T.T.



World Association of Technology Teachers

This exercise can be printed and used by teachers and students. It is recommended that you view the website (www.technologystudent.com) before attempting the design sheet .

THESE MATERIALS CAN BE PRINTED AND USED BY TEACHERS AND STUDENTS.
THEY MUST NOT BE EDITED IN ANY WAY OR PLACED ON ANY OTHER MEDIA INCLUDING WEB SITES AND INTRANETS.
NOT FOR COMMERCIAL USE.
THIS WORK IS PROTECTED BY COPYRIGHT LAW.
IT IS ILLEGAL TO DISPLAY THIS WORK ON ANY WEBSITE/MEDIA STORAGE OTHER THAN www.technologystudent.com

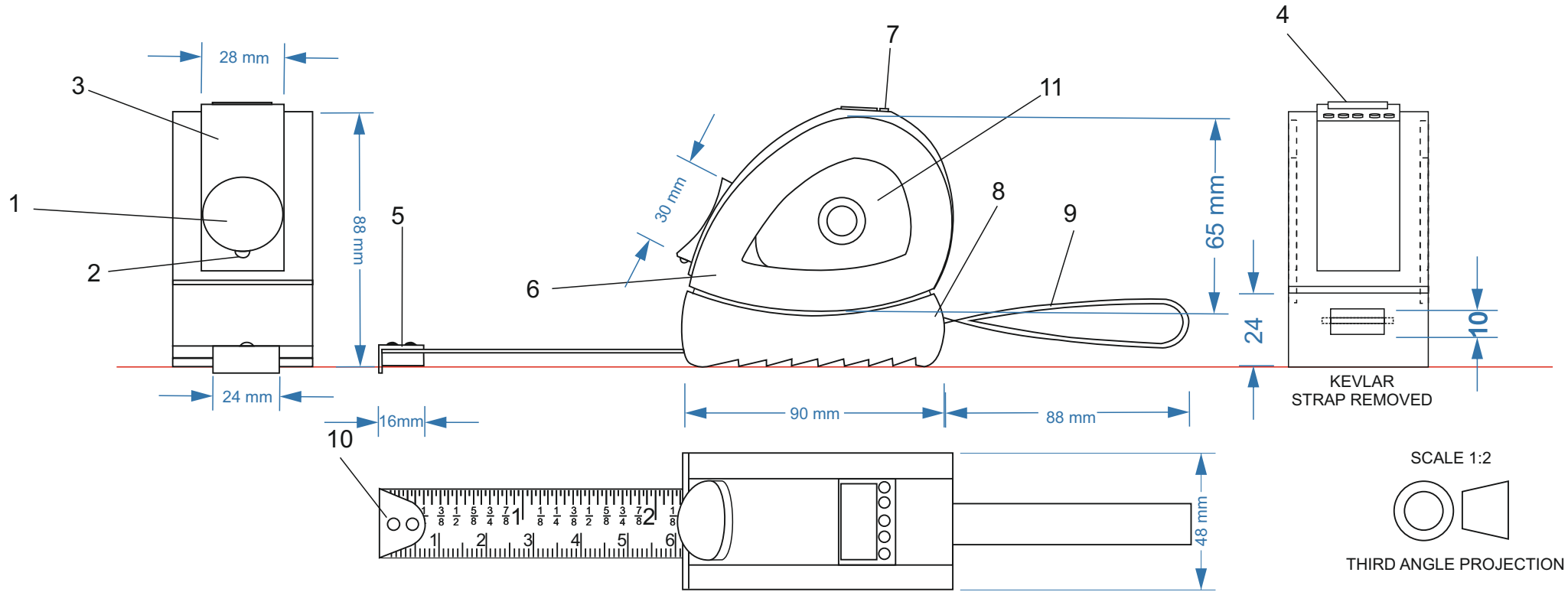

PART No	No OFF	DESCRIPTION	MATERIAL	DIMENSIONS	FINISH
1	1	ROCKER SWITCH	PVC	30x26x10mm	POLISHED
2	1	ULTRA BRIGHT LED	ELECTRONIC COMPONENT	Dia.5x10xmm	N/A
3	1	FLEXIBLE SOLAR PANEL	ELECTRONIC COMPONENT	110x28x3mm	N/A
4	1	LCD - DISPLAY	ELECTRONIC COMPONENT	15x25x5mm	N/A
5	1	END GRIP	ALUMINIUM	16x8x24mm	BRUSHED
6	2	CASING	POLYETHYLENE	65x90x24mm	POLISHED
7	5	FUNCTION BUTTONS	STYROFLEX	Dia.4x8mm	TEXTURED
8	1	BOTTOM GRIP	SYNTHETIC RUBBER	90x24x48mm	TEXTURED
9	1	WRIST STRAP	KEVLAR	88x26x2mm	WOVEN
10	2	PAN HEAD RIVETS	ALUMINIUM	DIA3x15mm	PLANISHED
11	2	TRANSLUCENT WINDOW	POLYETHYLENE	40x35x2mm	POLISHED

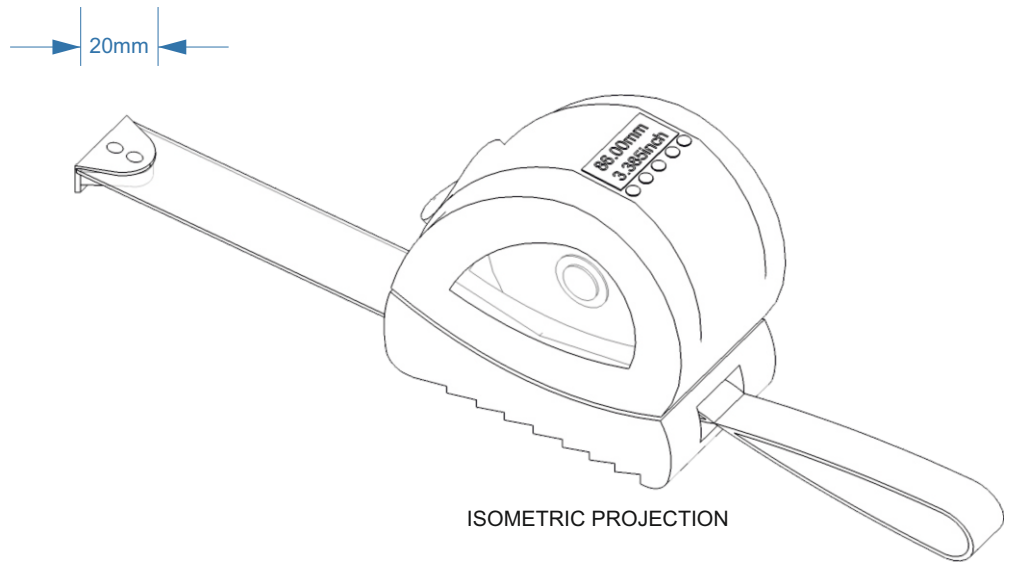

ISOMETRIC PROJECTION

