

THE HAND VICE AND MACHINE VICE

TO ANSWER ALL THE QUESTIONS YOU WILL NEED TO DOWNLOAD THE 'WORKING WITH METALS - PART TWO' APP, FROM THE INTERACTIVE MOBILE APP SECTION OF www.technologystudent.com

LINK

http://www.technologystudent.com/mobapps/engineering_equipment1.pdf

Once you have downloaded the App, you can use it to navigate the website. You may need to follow the links on each page of the App, to research / complete answers to all the questions.

**ARE YOU READY?
USE THE MOBILE App!!**

1 WHEN IS A HAND VICE USED TO HOLD MATERIAL?

Two sample hand vices are seen opposite.



2 EXPLAIN WHY A MACHINE VICE IS BEING USED TO SECURE MATERIAL ON THE DRILLING MACHINE, AS SEEN BELOW.

Write your answer in the next box.

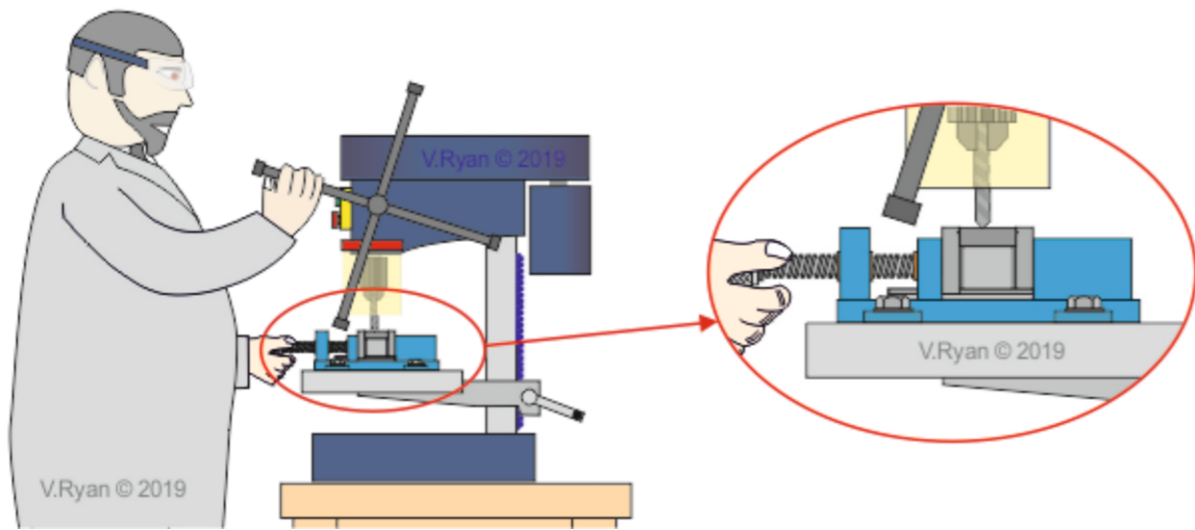

WRITE YOUR ANSWER HERE.

3 WHAT IS THE DIFFERENCE BETWEEN THE FOLLOWING MACHINE VICES:
HEAVY DUTY, MEDIUM DUTY, LIGHT DUTY

HELPFUL LINK: http://www.technologystudent.com/mobapps/engineering_equipment1.pdf

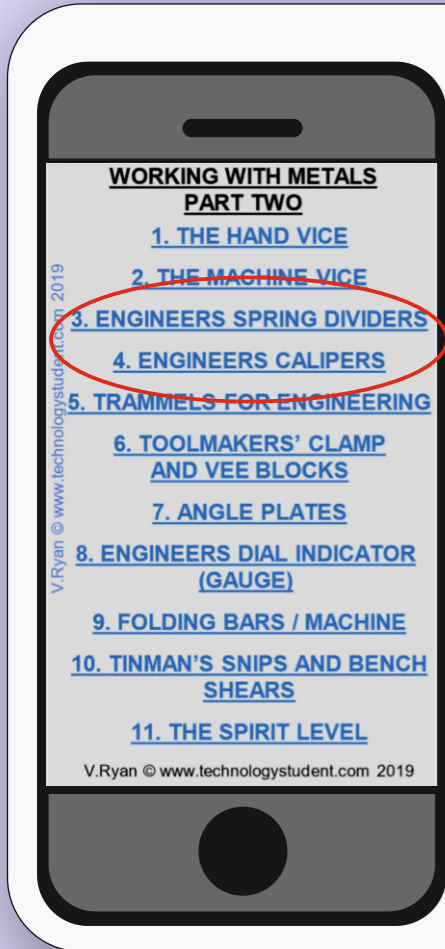

ENGINEERS SPRING DIVIDERS AND ENGINEERS CALIPERS

TO ANSWER ALL THE QUESTIONS YOU WILL NEED TO DOWNLOAD THE 'WORKING WITH METALS - PART TWO' APP, FROM THE INTERACTIVE MOBILE APP SECTION OF www.technologystudent.com

LINK

http://www.technologystudent.com/mobapps/engineering_equipment1.pdf

Once you have downloaded the App, you can use it to navigate the website. You may need to follow the links on each page of the App, to research / complete answers to all the questions.

**ARE YOU READY?
USE THE MOBILE App!!**

1

WHAT IS THE FUNCTION(S) OF ENGINEERS SPRING DIVIDERS?



SKETCH ONE USE / FUNCTION OF ENGINEERS SPRING DIVIDERS.

2

WITH THE AID OF A SKETCH, DESCRIBE HOW 'ODD LEG CALIPERS' CAN BE USED TO 'SCRIBE' A PARALLEL LINE.

Sketch

Notes

| | |
|---|---|
| <hr/> <hr/> <hr/> <hr/> <hr/> <hr/> <hr/> <hr/> | <hr/> <hr/> <hr/> <hr/> <hr/> <hr/> <hr/> <hr/> |
|---|---|

3

STUDY HOW THESE ODD LEG CALIPERS ARE BEING USED. WHAT IS HAPPENING?

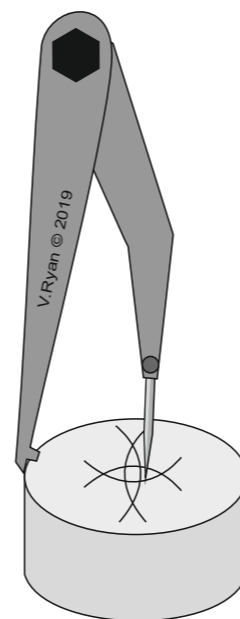

4

NAME THE TWO CALIPERS SHOWN HERE.

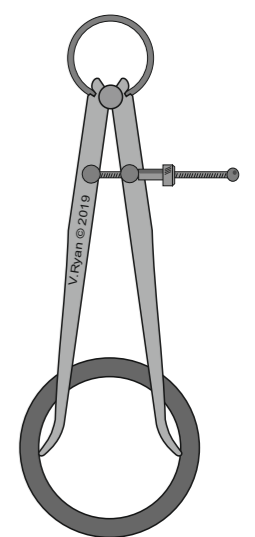
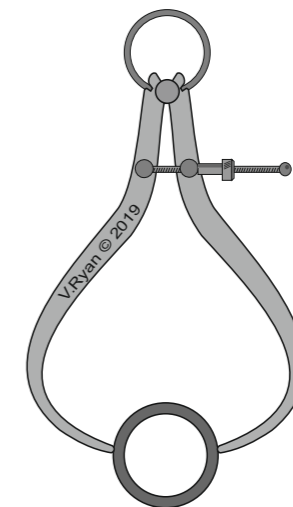

HELPFUL LINK: http://www.technologystudent.com/mobapps/engineering_equipment1.pdf

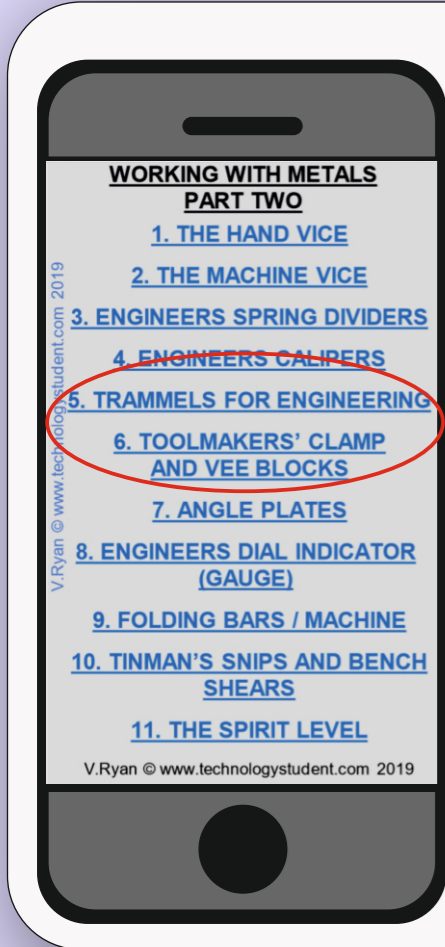

TRAMMELS AND THE TOOLMAKER'S CLAMP

TO ANSWER ALL THE QUESTIONS YOU WILL NEED TO DOWNLOAD THE 'WORKING WITH METALS - PART TWO' APP, FROM THE INTERACTIVE MOBILE APP SECTION OF www.technologystudent.com

LINK

http://www.technologystudent.com/mobapps/engineering_equipment1.pdf

Once you have downloaded the App, you can use it to navigate the website. You may need to follow the links on each page of the App, to research / complete answers to all the questions.

**ARE YOU READY?
USE THE MOBILE App!!**

1

USING NOTES AND A SKETCH, DESCRIBE HOW A TRAMMEL CAN BE USED TO DRAW / SCRIBE, AN ARC ON SHEET METAL.

2

A TOOLMAKER'S CLAMP IS SHOWN BELOW. USING NOTES AND A SKETCH, EXPLAIN HOW THE TOOLMAKER'S CLAMP CAN BE USED TO HOLD / SECURE METAL, DURING PRACTICAL WORK.

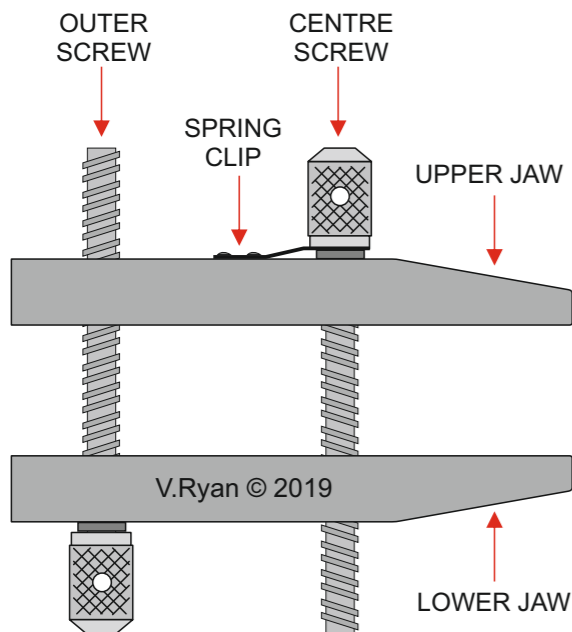

Sketch

Notes

HELPFUL LINK:

http://www.technologystudent.com/mobapps/engineering_equipment1.pdf

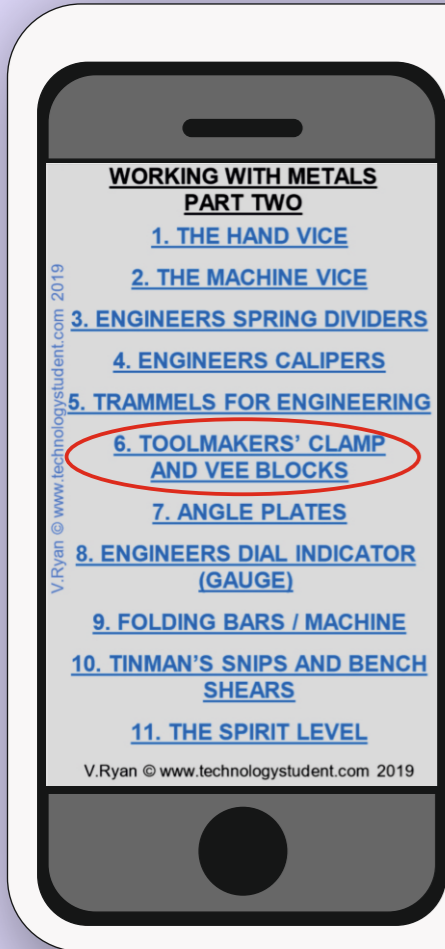

ENGINEERS SPRING DIVIDERS AND ENGINEERS CALIPERS

TO ANSWER ALL THE QUESTIONS YOU WILL NEED TO DOWNLOAD THE 'WORKING WITH METALS - PART TWO' APP, FROM THE INTERACTIVE MOBILE APP SECTION OF www.technologystudent.com

LINK

http://www.technologystudent.com/mobapps/engineering_equipment1.pdf

Once you have downloaded the App, you can use it to navigate the website. You may need to follow the links on each page of the App, to research / complete answers to all the questions.

**ARE YOU READY?
USE THE MOBILE App!!**

1

WHAT ARE CLAMPS WITH VEE BLOCKS? NAME THE MATERIALS THEY ARE MANUFACTURED FROM.

Example of a Clamp and Vee Block seen opposite.



CLAMP AND VEE BLOCK.

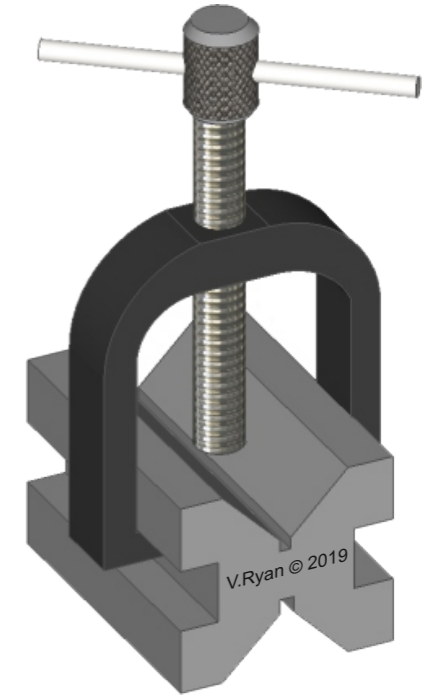

2

PRODUCE TWO SKETCHES, THAT SHOW DIFFERENT WAYS CLAMPS AND VEE BLOCKS CAN BE USED IN A WORKSHOP SITUATION. ADD A VERY BRIEF DESCRIPTION TO EACH SKETCH.

| | |
|---|---|
| <hr/> <hr/> <hr/> <hr/> <hr/> <hr/> <hr/> <hr/> | <hr/> <hr/> <hr/> <hr/> <hr/> <hr/> <hr/> <hr/> |
|---|---|

HELPFUL LINK: http://www.technologystudent.com/mobapps/engineering_equipment1.pdf

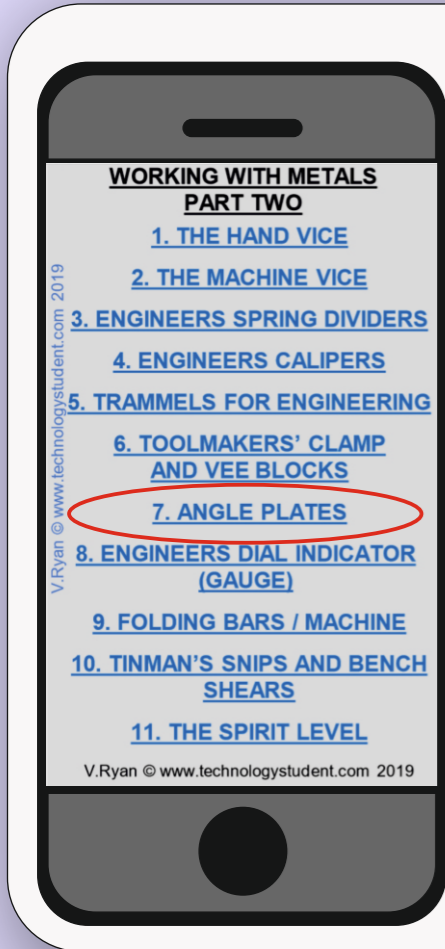

ENGINEERS SPRING DIVIDERS AND ENGINEERS CALIPERS

TO ANSWER ALL THE QUESTIONS YOU WILL NEED TO DOWNLOAD THE 'WORKING WITH METALS - PART TWO' APP, FROM THE INTERACTIVE MOBILE APP SECTION OF www.technologystudent.com

LINK

http://www.technologystudent.com/mobapps/engineering_equipment1.pdf

Once you have downloaded the App, you can use it to navigate the website. You may need to follow the links on each page of the App, to research / complete answers to all the questions.

**ARE YOU READY?
USE THE MOBILE App!!**

1

**WHAT IS AN ANGLE PLATE?
WHAT IS IT FOR?**

Example of an Angle Plate, seen opposite.

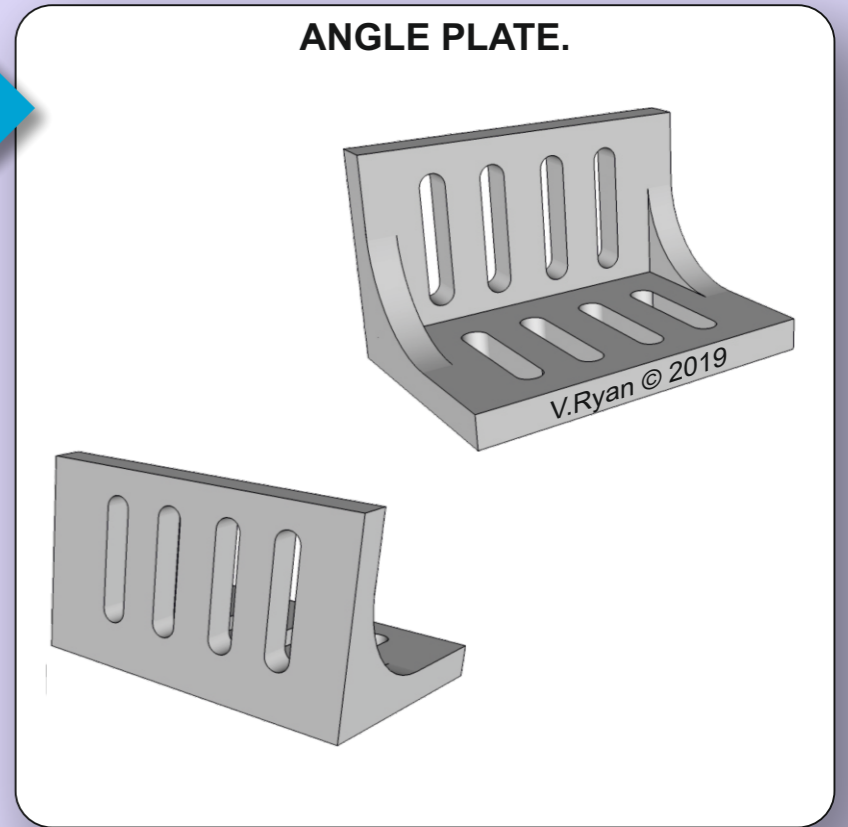

2

AN ANGLE PLATE, BOLTS AND SUPPORTING PACKAGING, IS SEEN IN USE BELOW. DESCRIBE HOW AND WHY THEY ARE BEING USED IN THIS WORKSHOP / ENGINEERING SITUATION.

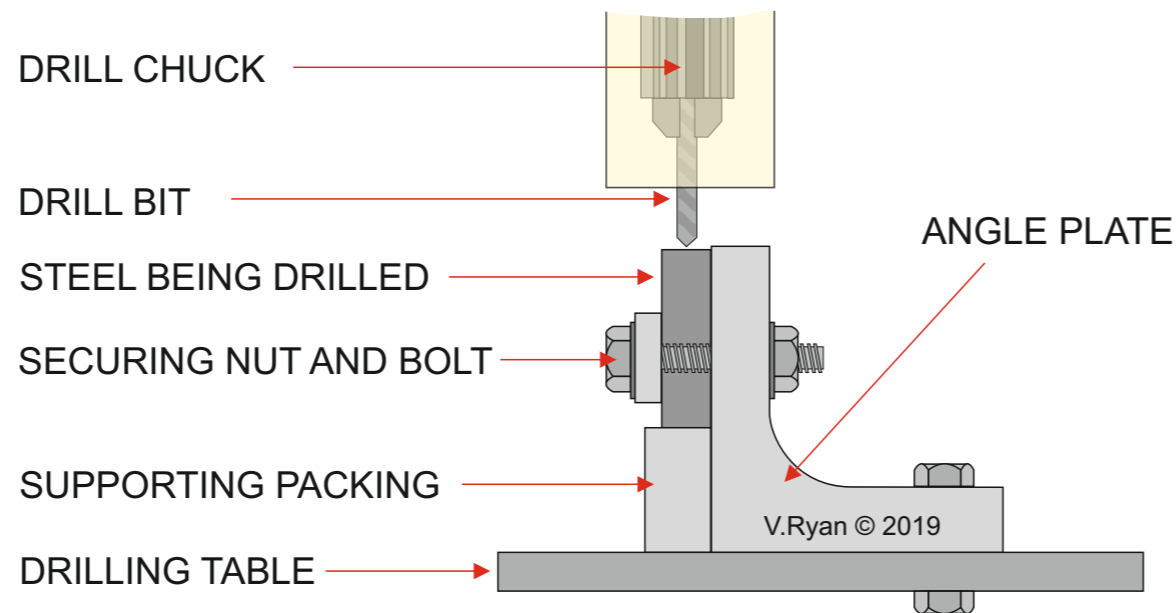
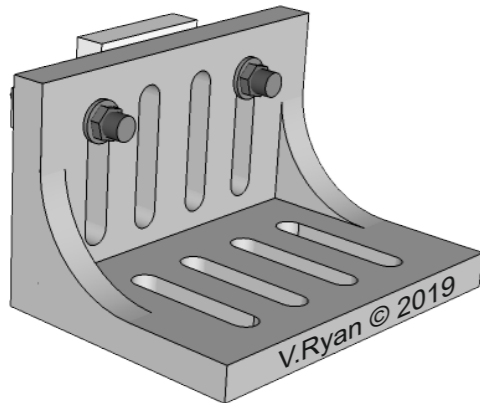

HELPFUL LINK: http://www.technologystudent.com/mobapps/engineering_equipment1.pdf

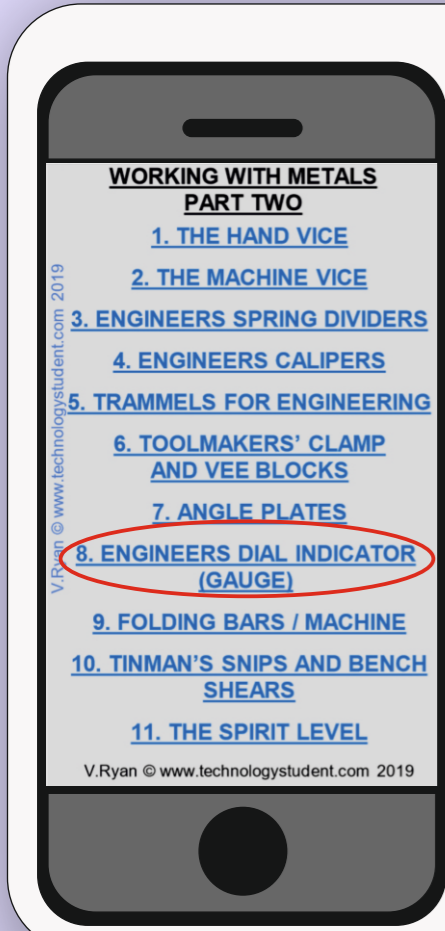

ENGINEERS SPRING DIVIDERS AND ENGINEERS CALIPERS

TO ANSWER ALL THE QUESTIONS YOU WILL NEED TO DOWNLOAD THE 'WORKING WITH METALS - PART TWO' APP, FROM THE INTERACTIVE MOBILE APP SECTION OF www.technologystudent.com

LINK

http://www.technologystudent.com/mobapps/engineering_equipment1.pdf

Once you have downloaded the App, you can use it to navigate the website. You may need to follow the links on each page of the App, to research / complete answers to all the questions.

**ARE YOU READY?
USE THE MOBILE App!!**

1 DESCRIBE THE GENERAL USE / PURPOSE OF THE ENGINEERS DIAL INDICATOR

Example of a Dial Indicator seen opposite.

ENGINEERS DIAL INDICATOR (GAUGE).

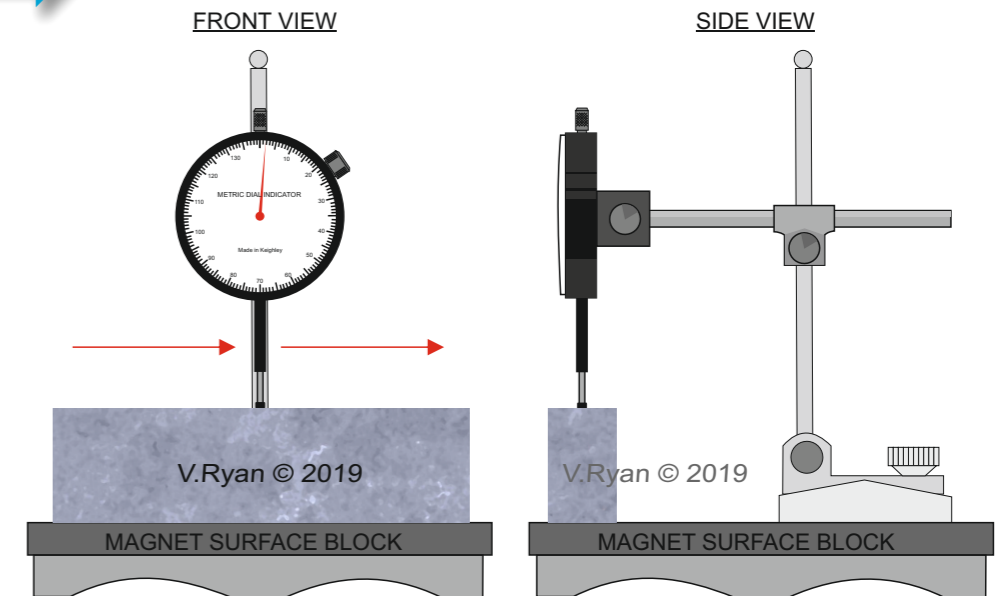

2 LABEL THE PARTS OF THE ENGINEERS DIAL INDICATOR.

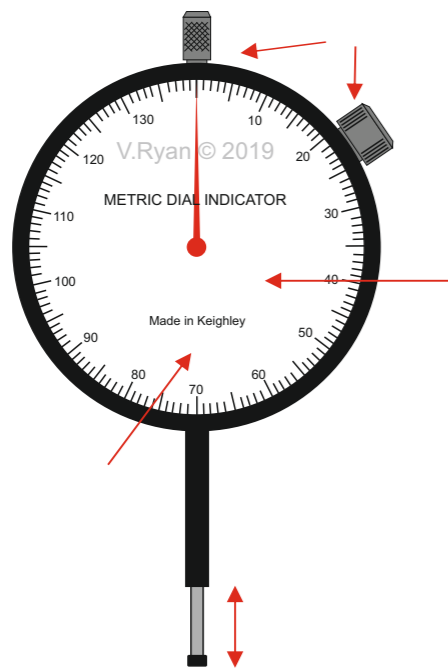

3 USING A SKETCH AND NOTES, EXPLAIN HOW A DIAL INDICATOR MOUNTED ON A MAGNETIC BASE, CAN BE USED IN CONJUNCTION WITH A CENTRE LATHE.

HELPFUL LINK: http://www.technologystudent.com/mobapps/engineering_equipment1.pdf

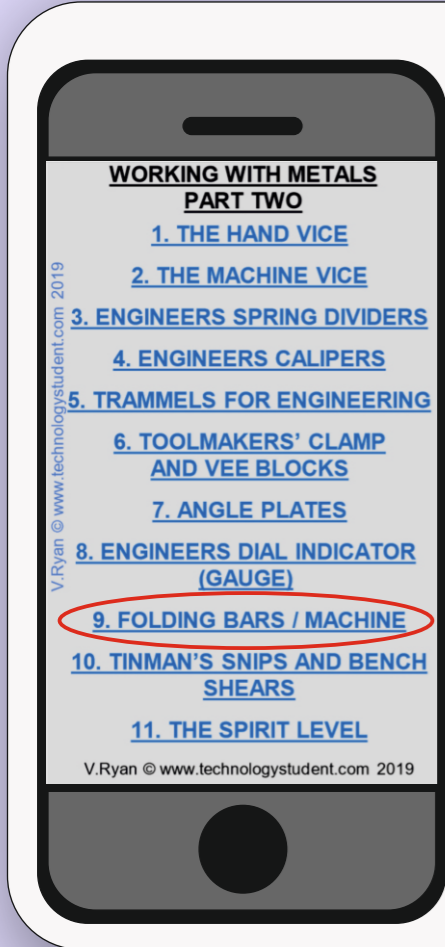

ENGINEERS SPRING DIVIDERS AND ENGINEERS CALIPERS

TO ANSWER ALL THE QUESTIONS YOU WILL NEED TO DOWNLOAD THE 'WORKING WITH METALS - PART TWO' APP, FROM THE INTERACTIVE MOBILE APP SECTION OF www.technologystudent.com

LINK

http://www.technologystudent.com/mobapps/engineering_equipment1.pdf

Once you have downloaded the App, you can use it to navigate the website. You may need to follow the links on each page of the App, to research / complete answers to all the questions.

**ARE YOU READY?
USE THE MOBILE App!!**

1

DESCRIBE HOW A SIMPLE SET OF FOLDING BARS CAN BE USED TO FOLD A SMALL PIECE OF SHEET METAL TO A 90 DEGREE ANGLE.

Place your sketch in the next box.



YOUR SKETCH.

2

WHAT IS THE FUNCTION OF A MANUALLY OPERATED SHEET METAL FOLDING MACHINE? INCLUDE ONE ADVANTAGE COMPARED TO FOLDING BARS.

3

DESCRIBE HOW THIS MANUALLY OPERATED SHEET METAL FOLDING MACHINE, IS USED.

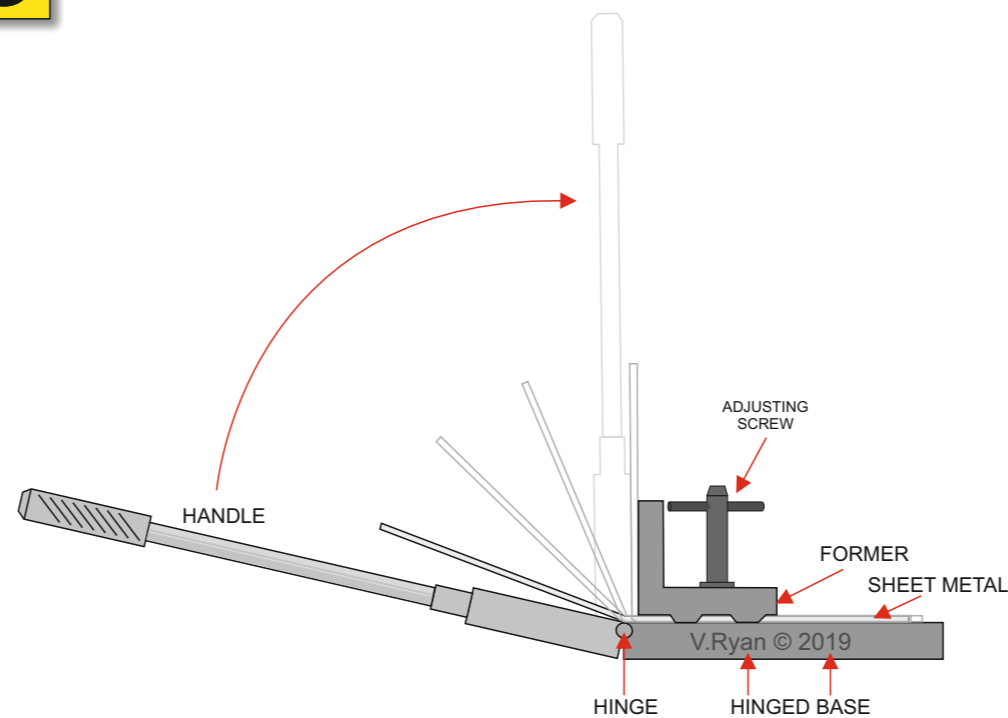

HELPFUL LINK: http://www.technologystudent.com/mobapps/engineering_equipment1.pdf

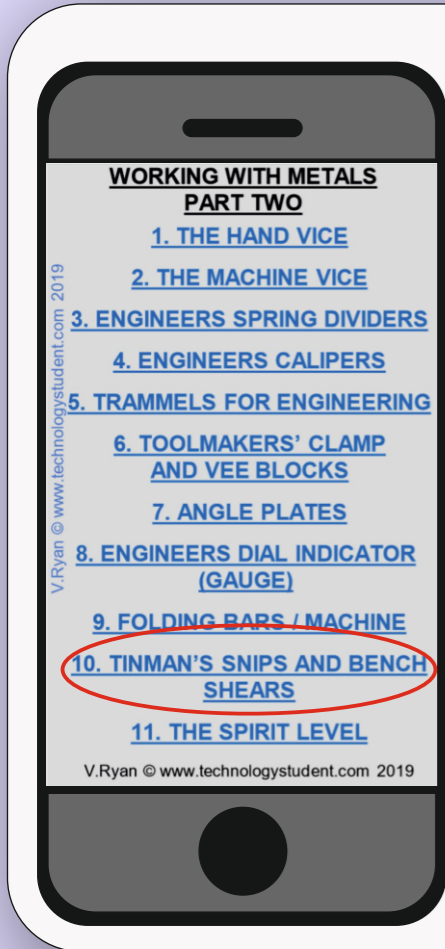

ENGINEERS SPRING DIVIDERS AND ENGINEERS CALIPERS

TO ANSWER ALL THE QUESTIONS YOU WILL NEED TO DOWNLOAD THE 'WORKING WITH METALS - PART TWO' APP, FROM THE INTERACTIVE MOBILE APP SECTION OF www.technologystudent.com

LINK

http://www.technologystudent.com/mobapps/engineering_equipment1.pdf

Once you have downloaded the App, you can use it to navigate the website. You may need to follow the links on each page of the App, to research / complete answers to all the questions.

**ARE YOU READY?
USE THE MOBILE App!!**

1

DESCRIBE THE TYPICAL USE OF A 'STRAIGHT TINMAN'S SNIPS', AS SEEN IN THE NEXT BOX.



TYPICAL USE OF A TINMAN'S SNIPS.

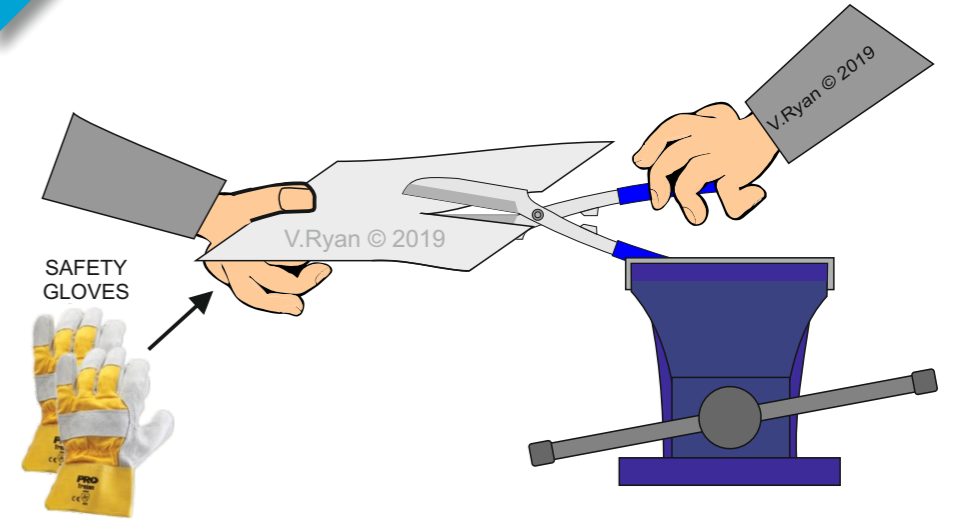

2

WHAT IS THE FUNCTION OF A CURVED TINMAN'S SNIPS



3

DESCRIBE HOW BENCH SHEARS ARE USED SAFELY. WHEN ARE THEY USED IN PREFERENCE TO TINMAN'S SNIPS?

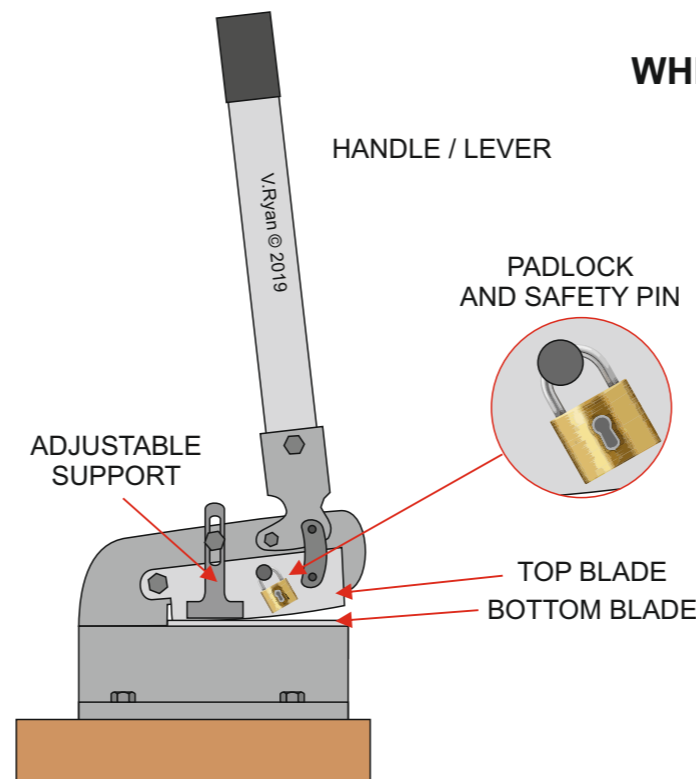

HELPFUL LINK: http://www.technologystudent.com/mobapps/engineering_equipment1.pdf