

EXAMINATION QUESTIONS - THE ENGINEERS VICE

HELPFUL LINKS:

http://www.technologystudent.com/equip_flsh/engvice1.html

1. Complete the diagram of the Engineers vice, by adding the missing parts. **6 marks**

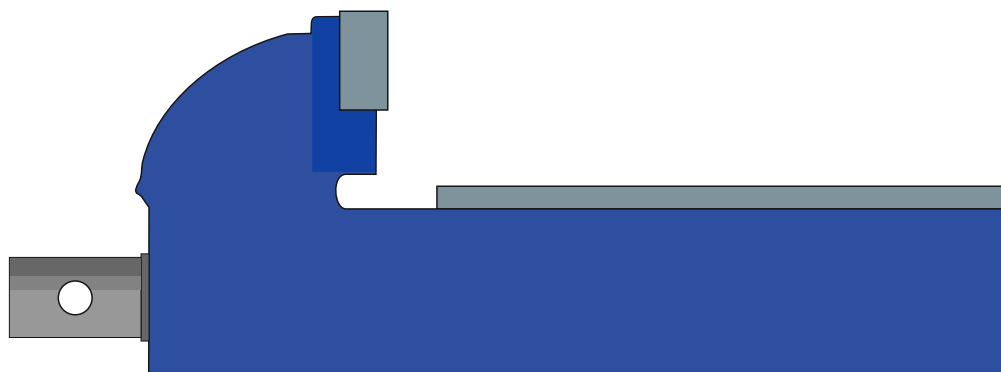

BENCH

2. Explain the use of fibre jaws, as shown opposite. **3 marks**



3. At the end of the working day, an engineers vice should not be left tightened. Why? **2 marks**

4. An engineers vice has two other common names. List the two alternative names for this vice. **2 marks**
