

MARKING OUT AND CUTTING A SINGLE SIDED DOVETAILED HOUSING JOINT

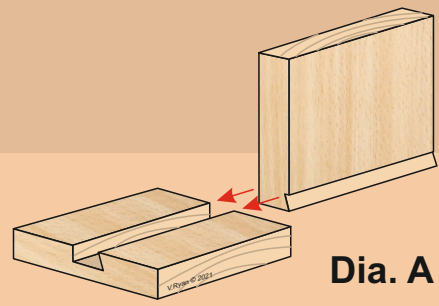

Dia. A

MARK THE 'FACE SIDE' AND 'FACE EDGE' ON BOTH PIECES OF WOOD.

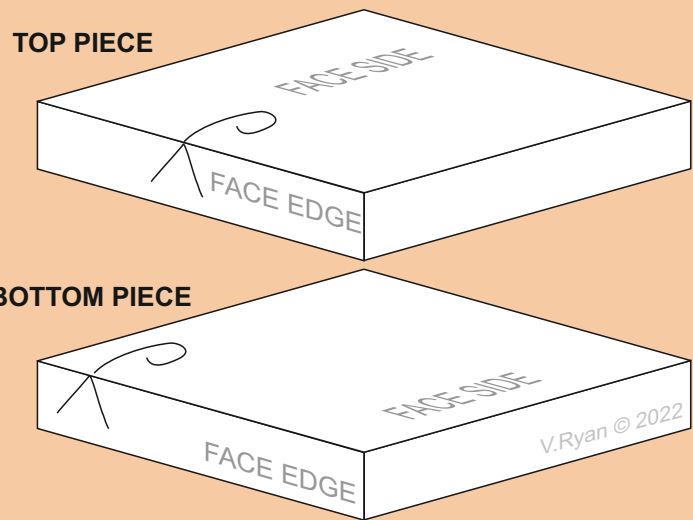

Dia. B
TOP PIECE

MARK THE DEPTH OF THE DOVETAIL AROUND THE WOOD, WITH A PENCIL. THIS IS CALLED THE SHOULDER LINE.

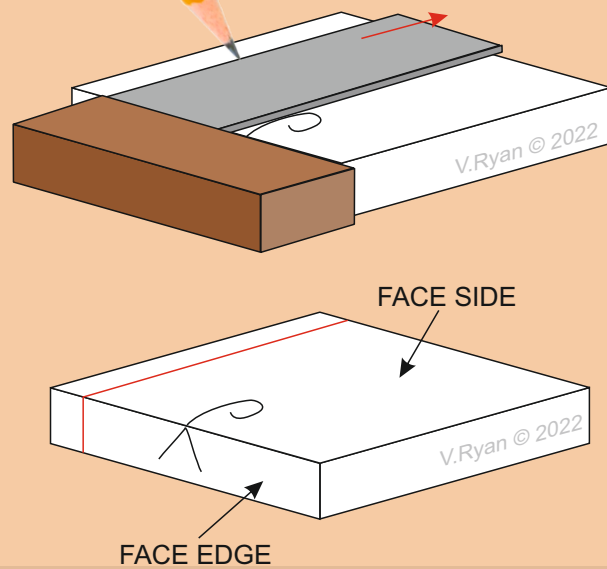

Dia. C

ADD THE 'ANGLE' OF THE DOVETAIL, USING A SLIDING BEVEL. SHADE THE WASTE WOOD.

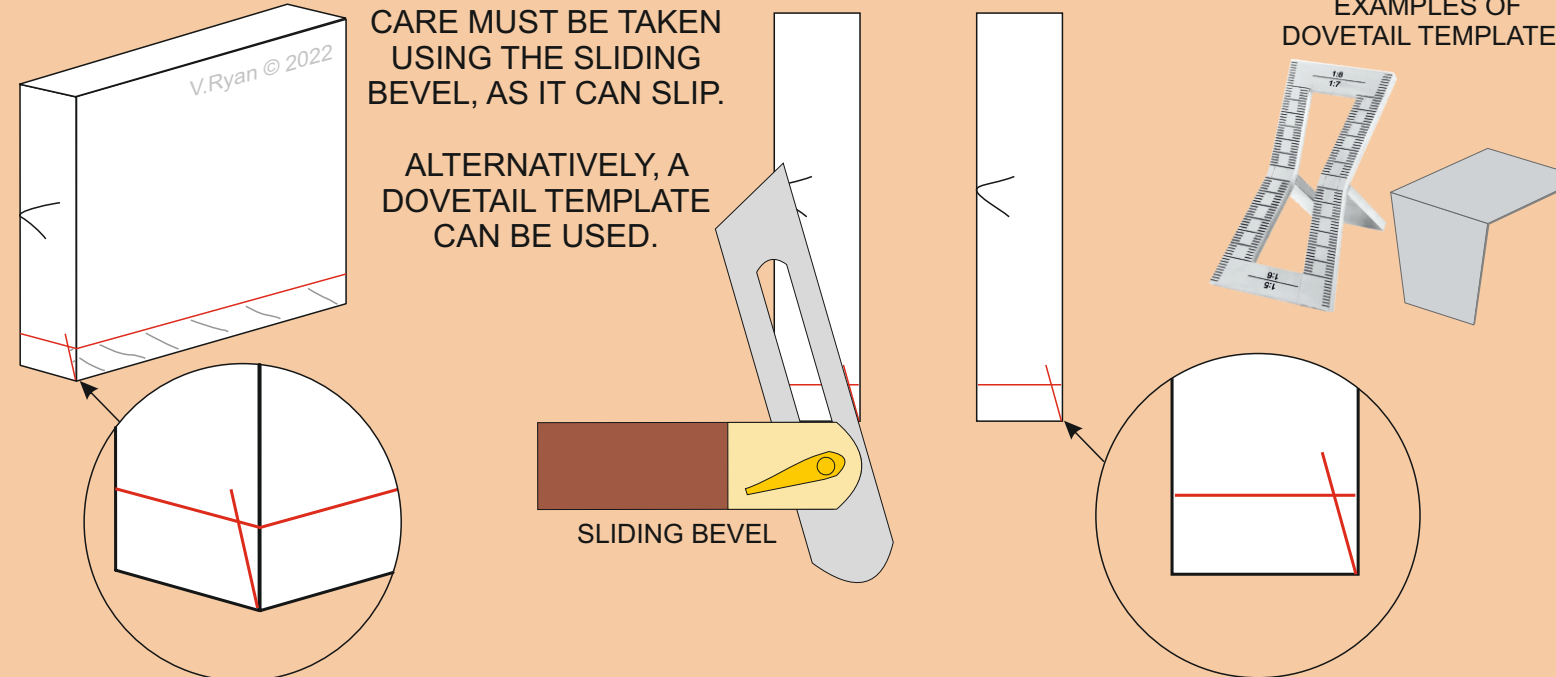

CARE MUST BE TAKEN USING THE SLIDING BEVEL, AS IT CAN SLIP.

ALTERNATIVELY, A DOVETAIL TEMPLATE CAN BE USED.

EXAMPLES OF DOVETAIL TEMPLATES

Dia. D

USE A MARKING KNIFE TO 'SCORE' OVER THE LINES, THAT WILL BE SAWN / CHISELLED

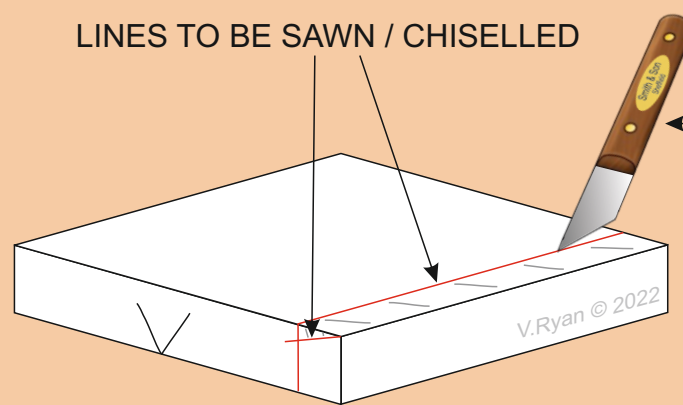

ALWAYS 'RUN' A MARKING KNIFE ALONG THE BLADE OF A TRY SQUARE / OR SAFETY EDGE, WHEN MARKING ACROSS THE WOOD. NEVER USE IT 'FREEHAND'.

USE A DOVETAIL / TENON SAW, TO SAW ON THE WASTE WOOD SIDE OF THE LINE.

TAKE CARE NOT TO SAW TOO FAR DOWN.



Dia. E

G-CLAMP THE WOOD SECURELY AND 'PARE' AWAY THE WASTE WOOD, WITH A CHISEL.

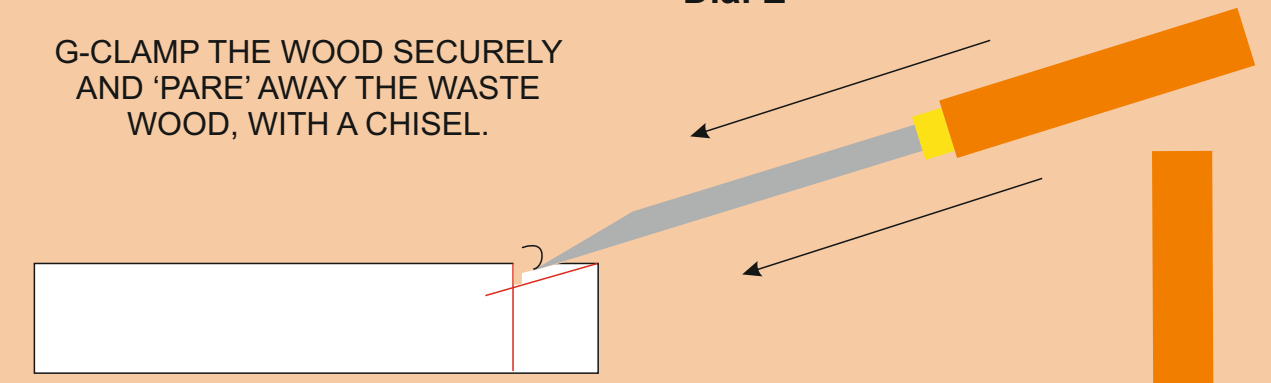

PLACE THE CUTTING EDGE OF THE CHISEL, IN THE KNIFE LINE, ACROSS THE SHOULDER AND TAP WITH A Mallet.

DO THIS ALONG THE LENGTH OF THE LINE. THIS WILL STRAIGHTEN THE SHOULDER'S EDGE.

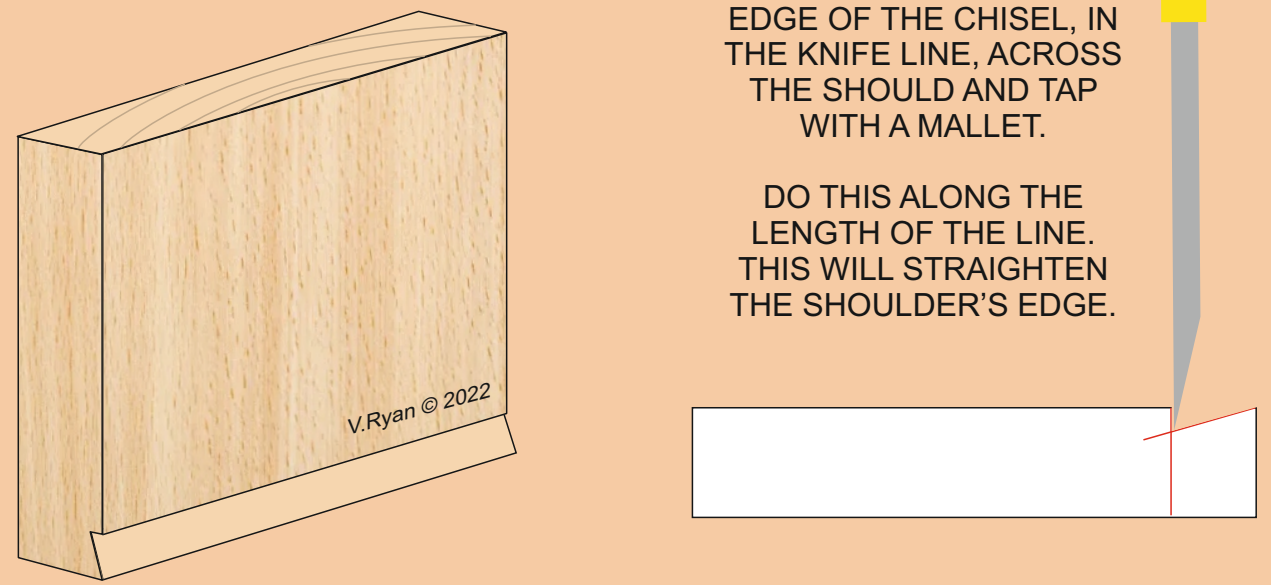

MARKING OUT AND CUTTING A SINGLE SIDED DOVETAILED HOUSING JOINT

Dia. F

BOTTOM PIECE

MARK THE POSITION OF THE TOP PIECE ON THE BOTTOM PIECE, USING A TRY SQUARE. A SINGLE LINE IS REQUIRED AT THIS STAGE.

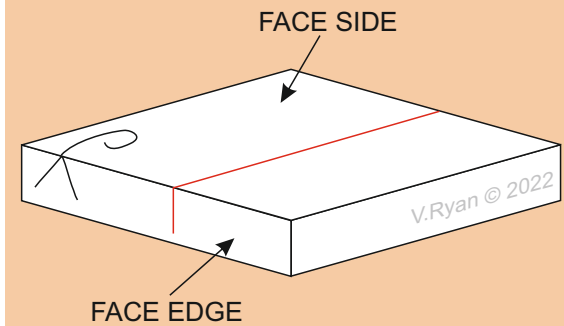

Dia. G

SECURE THE BOTTOM PIECE IN A VICE AND LOWER THE COMPLETED DOVETAILED PIECE, SO THAT IT 'LINES UP' WITH THE 'MARKING OUT LINE'.

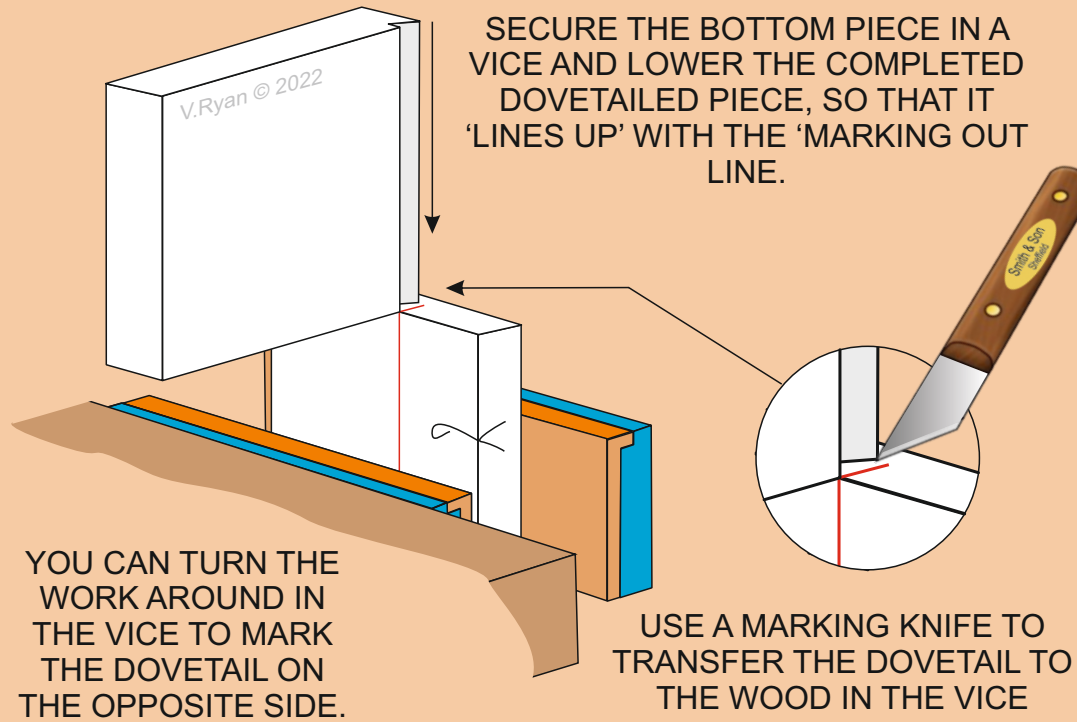

YOU CAN TURN THE WORK AROUND IN THE VICE TO MARK THE DOVETAIL ON THE OPPOSITE SIDE.

USE A MARKING KNIFE TO TRANSFER THE DOVETAIL TO THE WOOD IN THE VICE

Dia. H

CONTINUE THE MARKING OUT LINES ACROSS AND DOWN THE OTHER EDGE. USE A TRY SQUARE. GO OVER THE LINES WITH A PENCIL SO THAT THEY ARE EASY TO SEE.

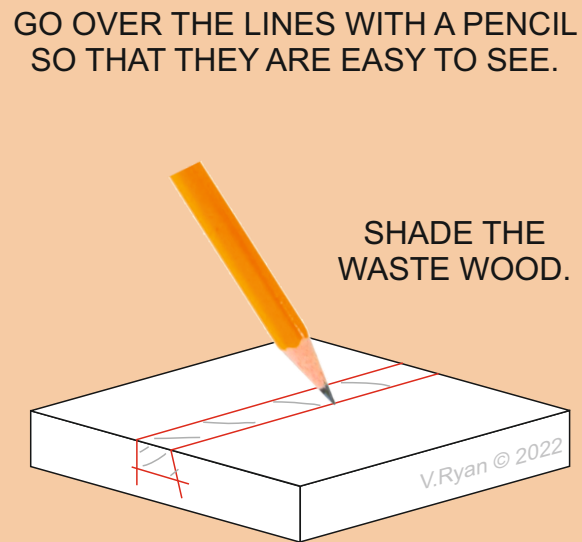

SHADE THE WASTE WOOD.

Dia. I

SECURE THE WOOD IN A VICE. SAW DOWN, CUTTING ON THE WASTE WOOD SIDE OF THE VERTICAL LINE.

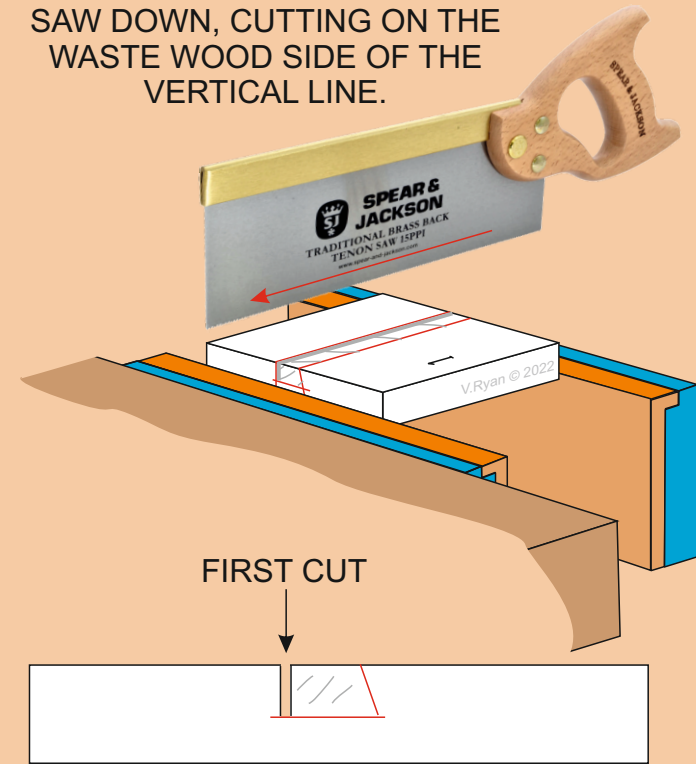

Dia. J

THE ANGLED CUT, CAN BE MADE BY TILTING THE SAW AT THE DOVETAIL ANGLE OR A FORMER, ALREADY CUT TO THE CORRECT ANGLE, CAN BE USED TO SUPPORT THE SAW. BOTH PIECES ARE G-CLAMPED TO THE BENCH.

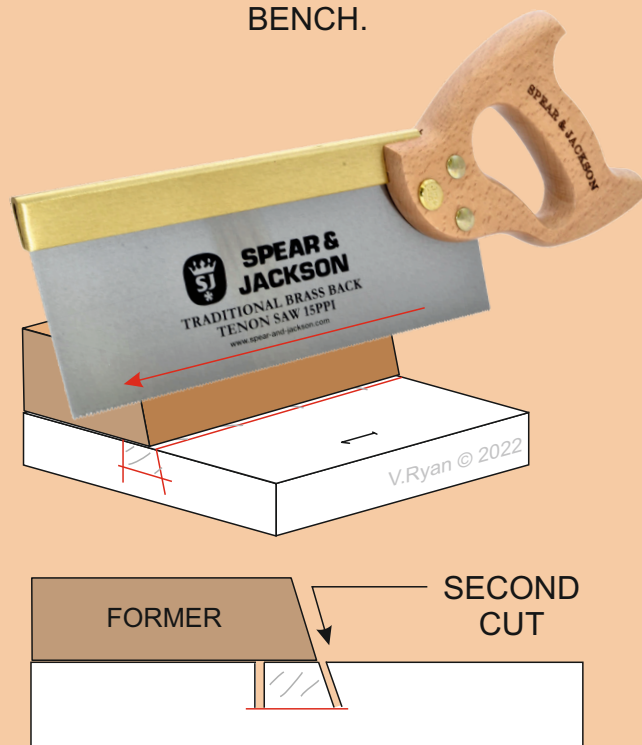

FORMER
SECOND CUT

Dia. K

SLOWLY REMOVE THE WASTE WOOD WITH A CHISEL (BEVEL EDGED PREFERRED), WORKING UPWARDS AND TOWARDS THE CENTRE (SEE DIA 1, 2 & 3 BELOW). DO NOT CHISEL ALL THE WAY ACROSS, AS THIS CAN SPLIT THE WOOD, AT THE FAR SIDE.

WHEN YOU HAVE CHISELLED HALF WAY ACROSS THE JOINT, TURN THE WORK ROUND IN THE VICE AND CHISEL THE SECOND HALF OF THE JOINT. FINALLY, STRAIGHTEN / LEVEL THE JOINT.

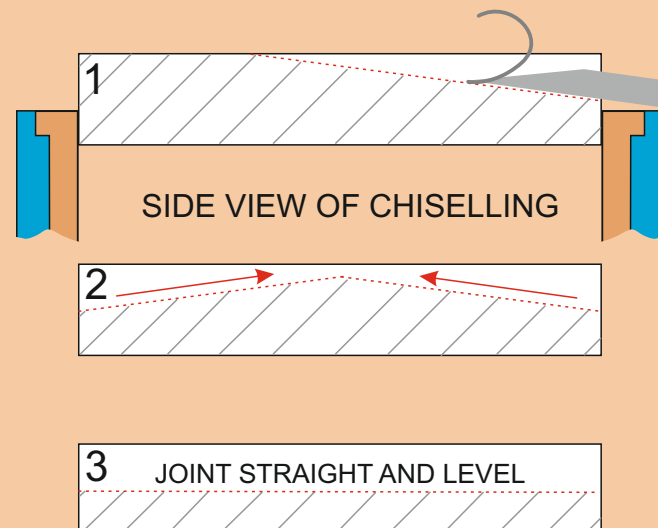

1 SIDE VIEW OF CHISELLING

2

3 JOINT STRAIGHT AND LEVEL

ALTERNATIVELY, A ROUTER PLANE CAN BE USED TO REMOVE MOST OF THE WASTE WOOD.



Dia. L

IF REQUIRED, THE VERTICAL LINE OF THE SHOULDER CAN BE TRIMMED WITH A CHISEL AND Mallet.

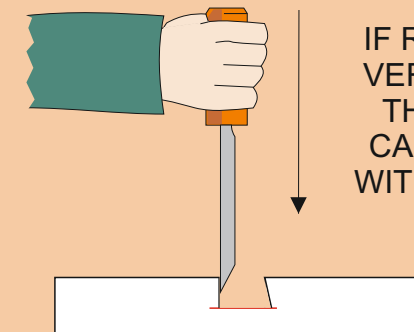

FIT THE JOINT TOGETHER

